



- Available transmission ratios: **1:1 - 1:2** (standard) - **2:1** (available in versions «A» - «B» - «C»); (Tab. 3).
- Ratios **1/2** and **2/1** are only available with spiral gears.
- Aluminium case, anodised; stainless steel shafts (standard).
- Torque **90 Nm**. Radial load **150 kg** - axial load **15 kg** (Tab. 4).
- Models (Tab. 1):
  - Version «A» with 2 outputs; weight 2500 g.
  - Version «B» with 3 outputs; weight 2700 g.
  - Version «C» (opposite rotation) with 3 outputs; weight 2770 g.
  - Version «D» with 3 outputs, 2 through hollow shafts; weight 2700 g.
- Standard output shafts: **M** = male **Ø14** / **F** = female **Ø14** (Tab. 9).

#### Available on request:

- Case in **stainless steel AISI 303**.
- Models with spiral bevel gears are available in all versions with transmission ratio **1/1** (Tab. 2).
- Schmiernippel lieferbar in allen Ausführungen (Tab. 5).

- Lieferbare Übersetzungen: **1:1 - 1:2** (standard) - **2:1** (Lieferbar in Ausführungen «A» - «B» - «C»); (Tab. 3).
- Übersetzungen **1/2** und **2/1** nur mit Spiralkegelräder lieferbar.
- Druckgussgehäuse, schwarz eloxiert; Wellen aus Edelstahl AISI 303.
- Drehmoment **90 Nm**. Radiallast **150 kg** - Axiallast **15 kg** (Tab. 4).
- Ausführungen (Tab. 1):
  - Version «A» mit 2 Ausgangswellen, Gewicht 2500 g.
  - Version «B» mit 3 Ausgangswellen, Gewicht 2700 g.
  - Version «C» mit 3 Ausgangswellen mit Rückwärtsdrehung, Gewicht 2770 g.
  - Version «D» mit 3 Ausgangswellen, 2 durchgehende Hohlwellen, Gewicht 2700 g.
- Standard output shafts: **M** = male **Ø20** / **F** = female **Ø20** (Tab. 9).

#### Lieferbar auf Anfrage:

- Gehäuse in **Edelstahl AISI 303**.
- Ausführungen mit Spiralkegelräder für Übersetzung **1/1** (Tab. 2).
- Grease fitting is available in all versions (Tab. 5).

CONFIGURATION AND DIRECTION OF ROTATION - KONFIGURATION UND UMDREHUNGSSINN

Tab. 1

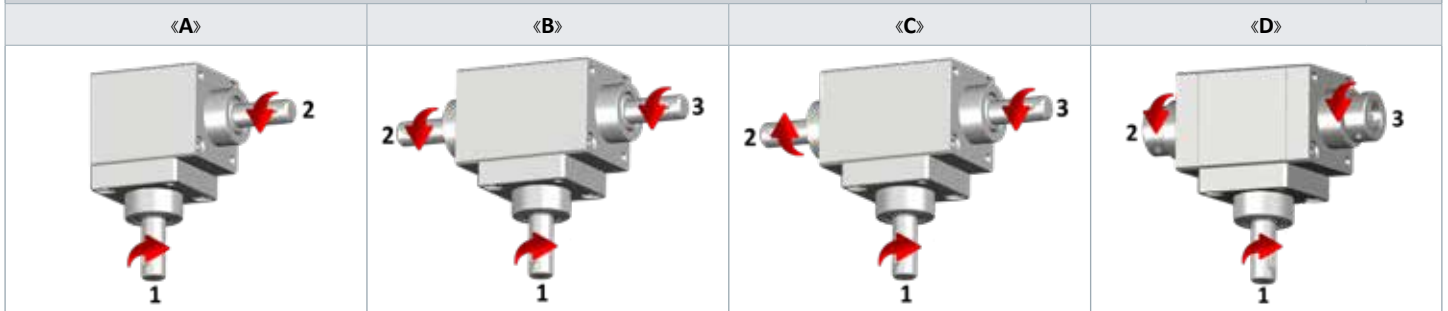

The direction of rotation depends from the configuration and from the positioning; see "Versions with dimension drawings".  
 Die Drehrichtung hängt von der Konfiguration und von der Positionierung ab; sehe "Ausführungen mit Abmessungen".

REPRESENTATION OF BEVEL GEARS - DARSTELLUNG VON KEGELRÄDER

Tab. 2

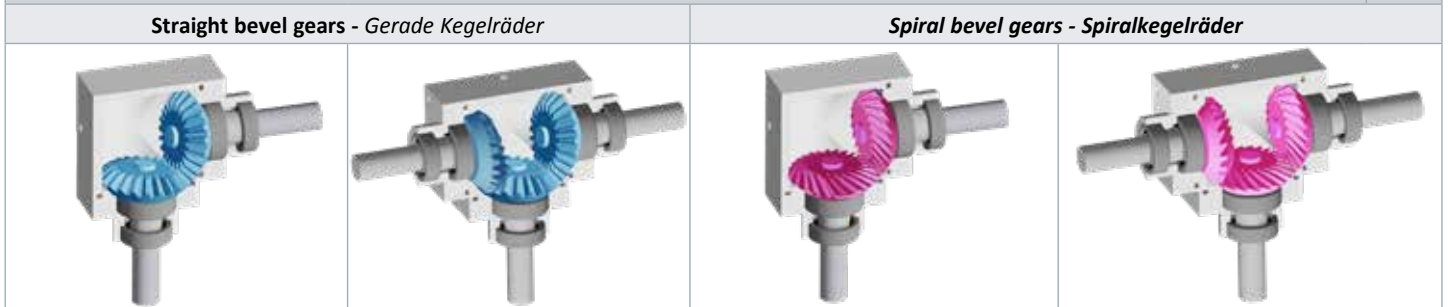

Moderate loads and speeds - Mittlere Lasten und Geschwindigkeiten

Loads + 30% and high speeds - + 30 % Lasten und hohe Geschwindigkeiten

REPRESENTATION OF TRANSMISSION RATIOS - DARSTELLUNG DER ÜBERSETZungsverHÄLTNISS

Tab. 3

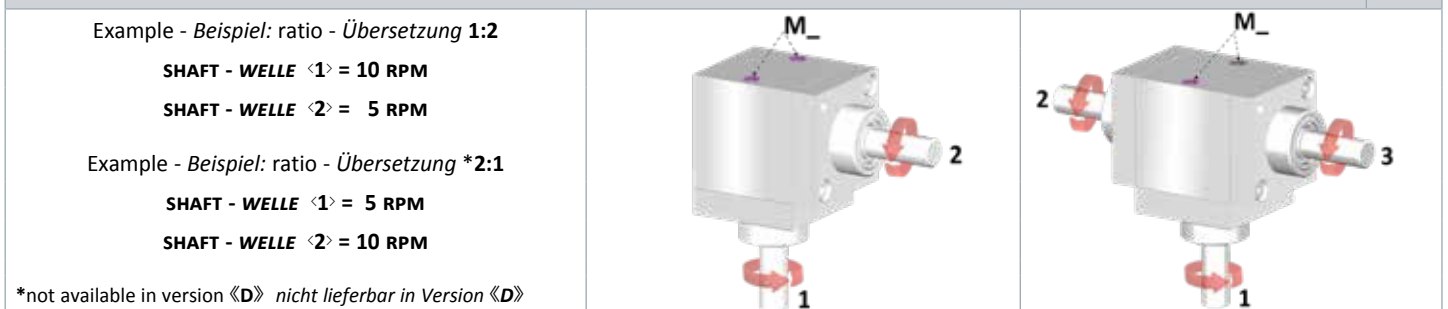

The ratio depends on shaft «1» shown opposite the fixing bores M<sub>-</sub> - Das Verhältnis hängt von der Welle 1 gegenüber den Befestigungsbohrungen M<sub>-</sub> ab.

REPRESENTATION OF DESIGN CONFIGURATION - DARSTELLUNG DER KONSTRUKTIVEN FORM

Tab. 4

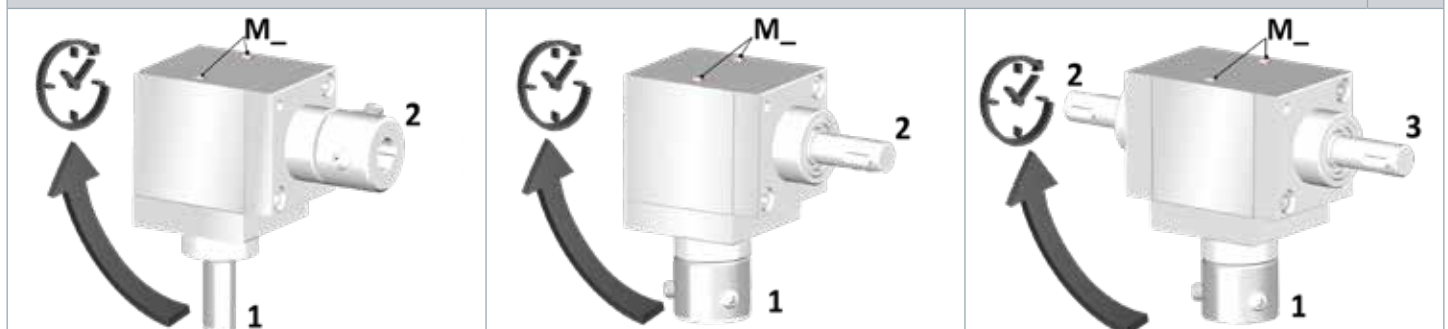

The design depends on shaft «1» opposite the fixing bores M<sub>-</sub>; others shafts follow clockwise (see "Part nr. configuration").  
 Durch Welle «1» bestimmt, die gegenüber der Befestigungsbohrungen M<sub>-</sub> liegt. Die anderen folgen den Uhrzeigersinn (siehe "Bestellmuster").

REPRESENTATION OF LOADS - DARSTELLUNG VON LASTEN

Tab. 5

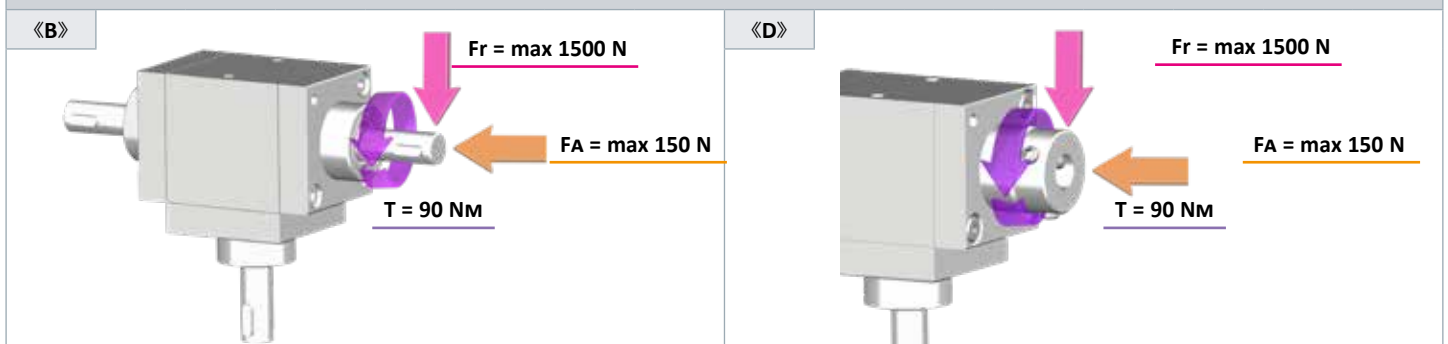

**Note:** a radial load (ex. belt tension) can only be applied to the long shaft of the «B» and «D» versions; otherwise, a support must be provided.  
**Hinweis:** radiale Belastung (z. B. Riemen­spannung) ist nur auf die lange Welle «B» und «D» erlaubt; andernfalls ist eine Abstützung nötig.

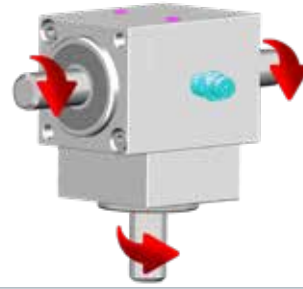
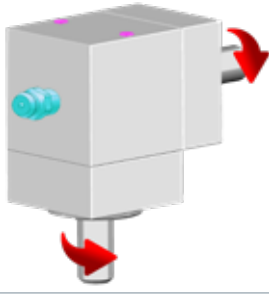

The grease fitting is standard as in images supplied; other positions on request - Standardposition gezeigt; alternative auf Anfrage.

VERSIONS WITH DIMENSION DRAWINGS - AUSFÜHRUNGEN MIT ABMESSUNGEN

AVAILABLE OUTPUT SHAFTS - LIEFERBARE AUSGANGSWELLEN

VERSION - AUSFÜHRUNG «A» M-M

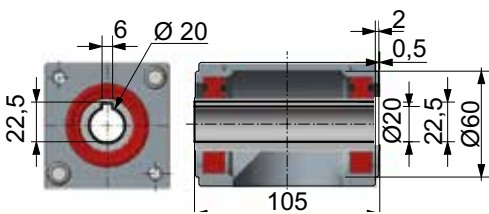
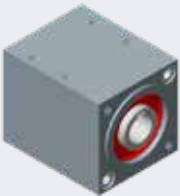
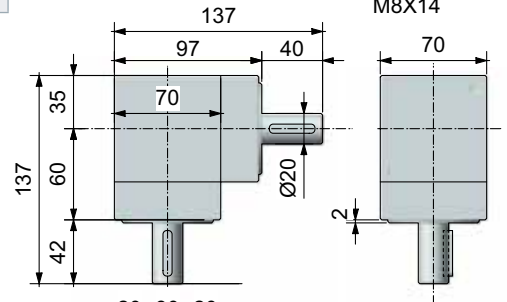
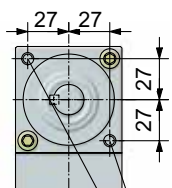
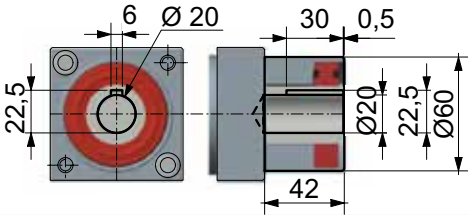
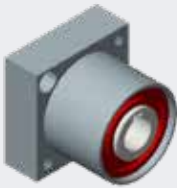
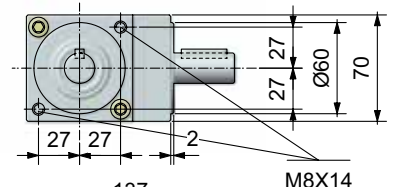
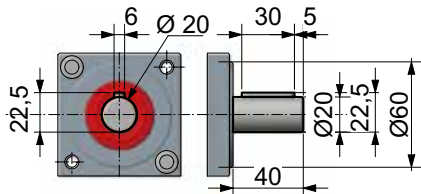

only for version "D" - nur für Version "D"

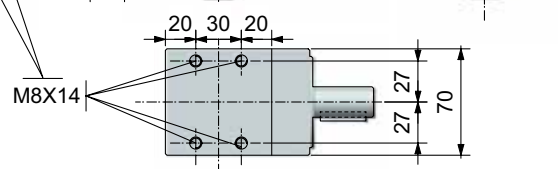
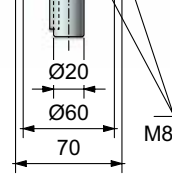

VERSION - AUSFÜHRUNG «A» M-F

VERSION - AUSFÜHRUNG «A» F-F

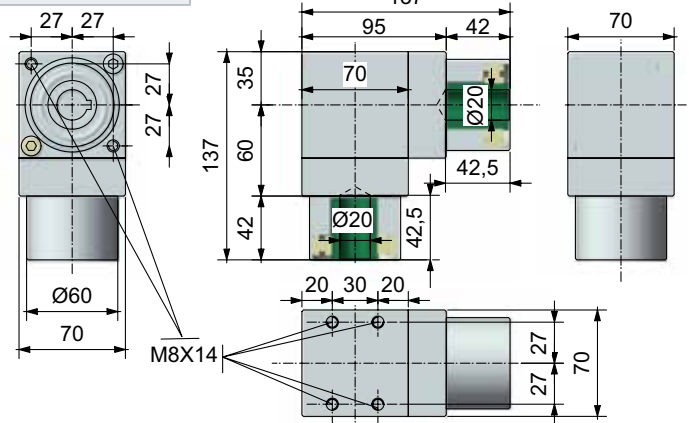
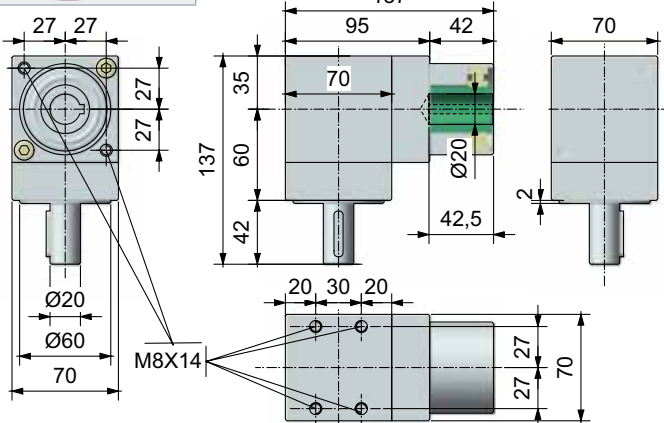
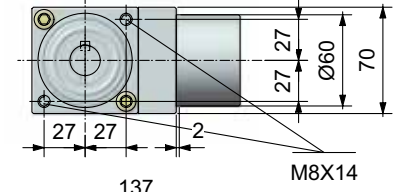
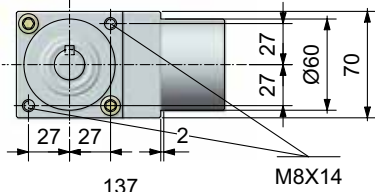

**VERSION - AUSFÜHRUNG «B» M-M-M**

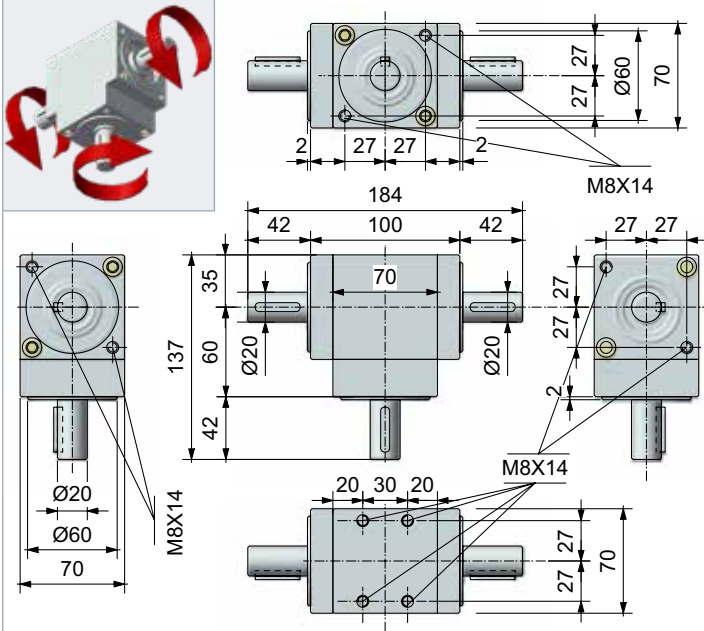

**VERSION - AUSFÜHRUNG «B» F-M-M**

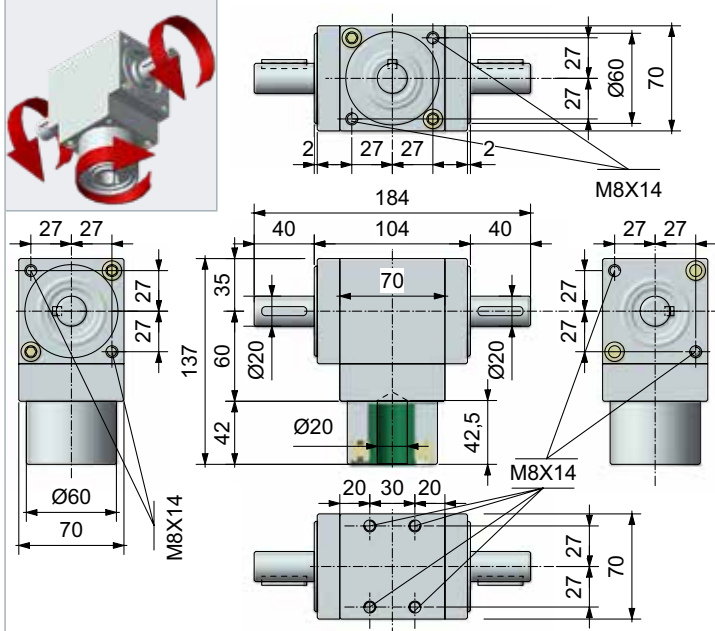

**VERSION - AUSFÜHRUNG «C» M-M-M OPPOSITE ROTATION - GEGENLÄUFIG**

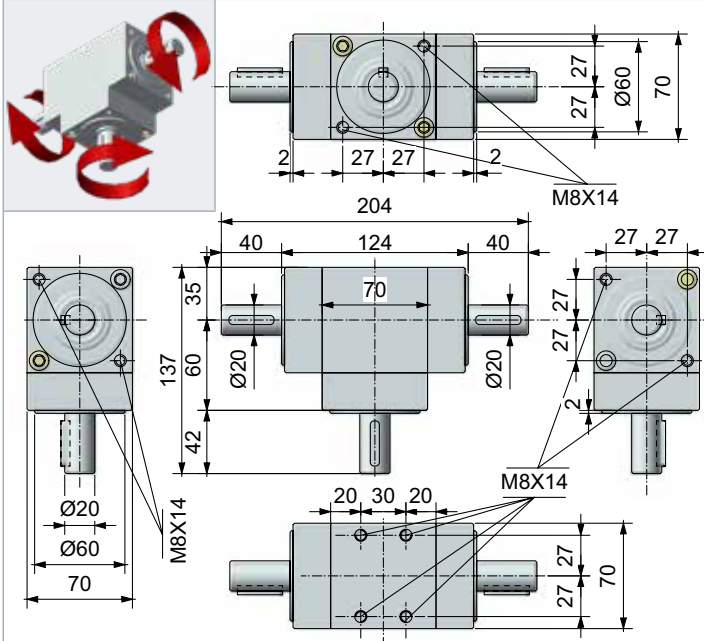

**VERSION - AUSFÜHRUNG «C» M-F-F OPPOSITE ROTATION - GEGENLÄUFIG**

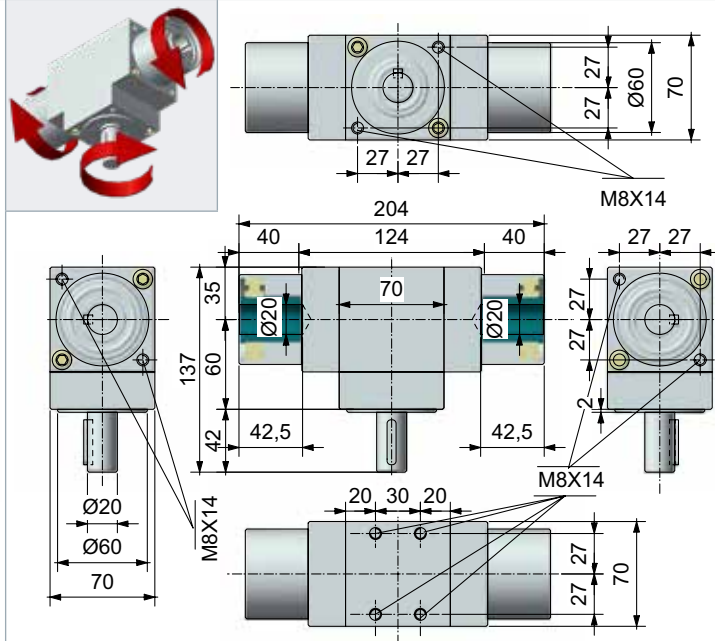

**VERSION - AUSFÜHRUNG «C» F-M-M OPPOSITE ROTATION - GEGENLÄUFIG**

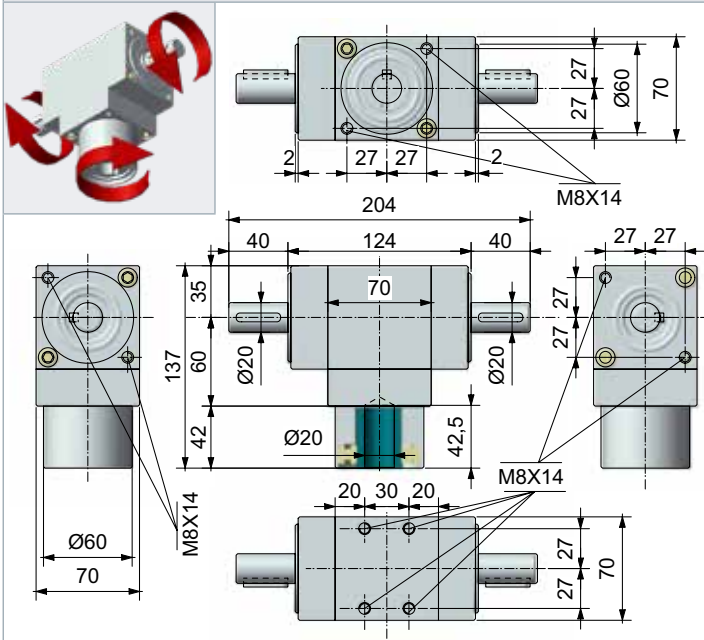

**VERSION - AUSFÜHRUNG «C» F-F-F OPPOSITE ROTATION - GEGENLÄUFIG**

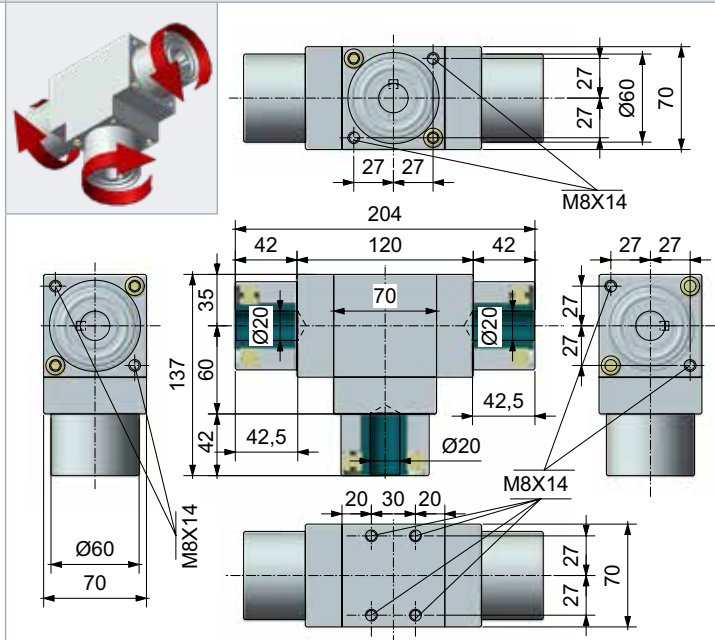



**VERSION - AUSFÜHRUNG «D» M-F-F ALBERO PASSANTE - THROUGH-HOLLOW SHAFT**

**VERSION - AUSFÜHRUNG «D» F-F-F ALBERO PASSANTE - THROUGH-HOLLOW SHAFT**

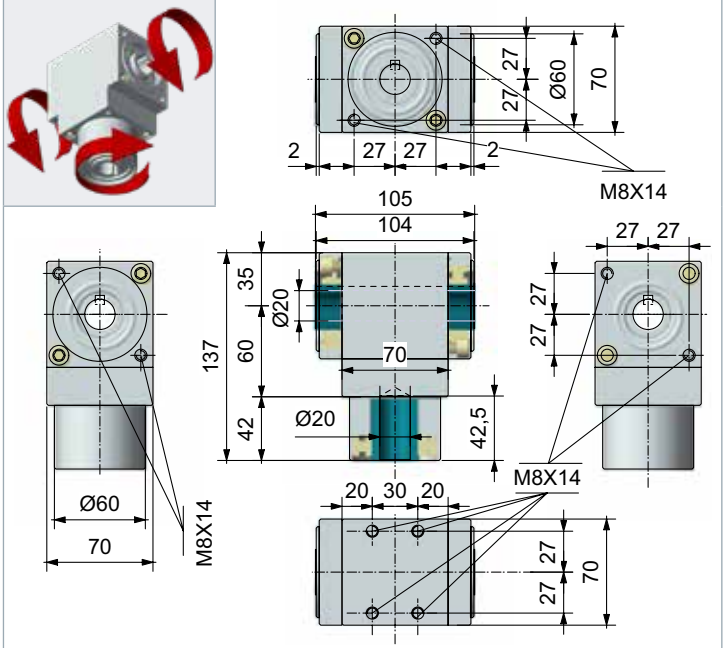
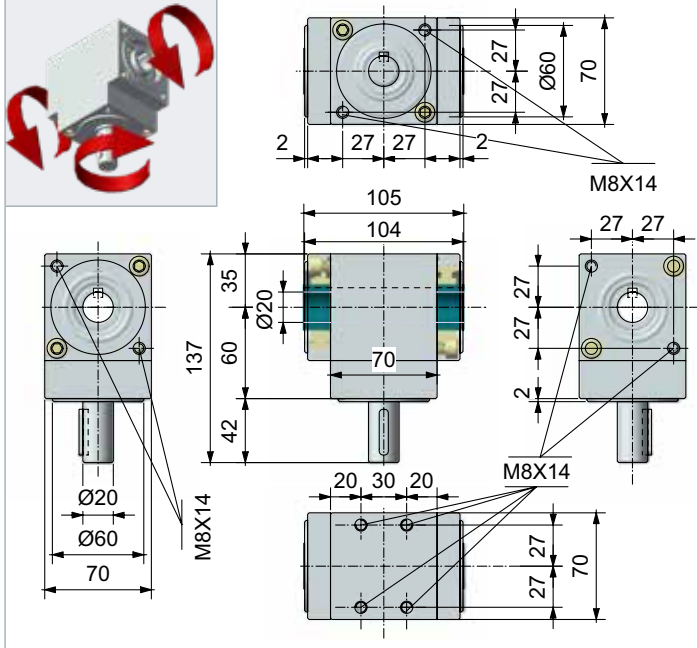

**EFFICIENCY DIAGRAMS AND TABLES - LEISTUNGSDIAGRAMME UND TABELLEN**

**Tab. 10**

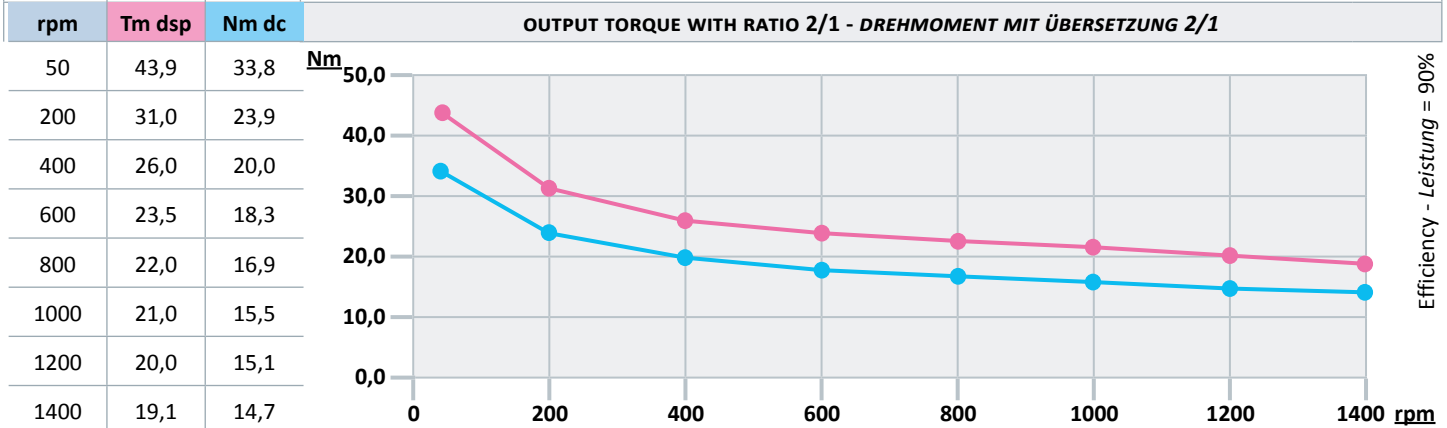
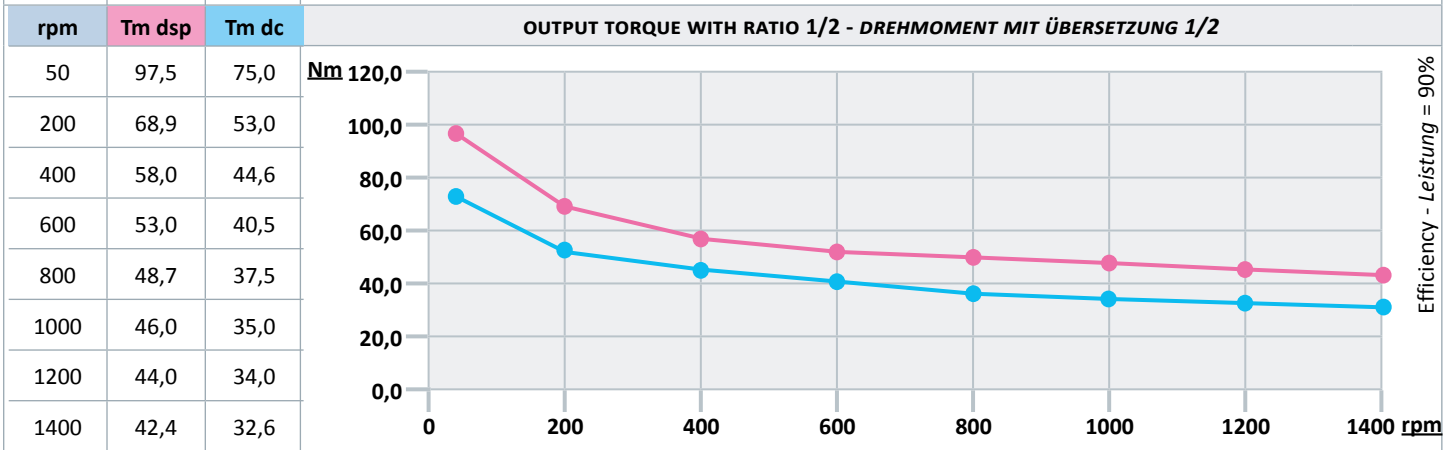
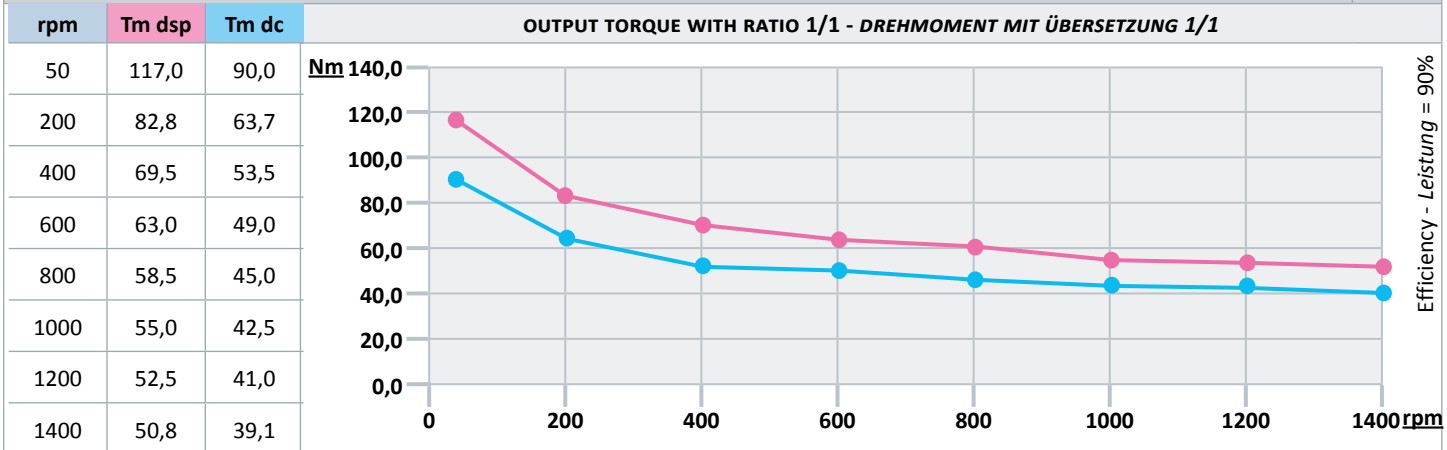

PART NR. CONFIGURATION - BESTELLMUSTER

66/8

SP

IN

B

MØ20

FØ20

FØ20

1/1

ING

SPIRAL BEVEL GEARS - SPIRALKEGELRÄDER (☛Tab. 2)

SP ratio - Übersetz. 1/1 ratio - Übersetz. 1/2 - 2/1

STAINLESS STEEL - EDELSTAHL

INOX

VERSION - AUSFÜHRUNG (☛Tab. 1)

A - B - C - D

SHAFT 1 - WELLE 1 (☛Tab. 9)

MØ20 - FØ20 (standard)

SHAFT 2 - WELLE 2 (☛Tab. 9)

MØ20 - FØ20 (standard)

SHAFT 3 - WELLE 3 (☛Tab. 9)

MØ20 - FØ20 (standard)

RATIO - ÜBERSETZUNG

1:1 - 1:2 - 2:1 (☛Tab. 3)

GREASE FITTING - SCHMIERNIPPEL (☛Tab. 5)

ING

exclusive option - keine Auswahl

optional - auf Wunsch lieferbar

- **Tm** = max torque in Nm - max Drehmoment in Nm

- **dc** = bevel gearing - Kegelradverzahnung

- **dsp** = spiral gearing - Spiralverzahnung

- Per la scelta del rinvio, consigliamo di consultare le tabelle e i dati tecnici riportati nelle "Informazioni generali" di questo catalogo (pag. 4 - 7)

- Per abbreviazioni e sigle consultare il «glossario» nelle "Informazioni generali" di questo catalogo (pag. 7).

- For the selection of the gearbox, we advise to consult the tables, and the technical data shown in the "General Information" of this catalog (p. 4 - 7)

- For abbreviations and acronyms consult the «glossary» in the "General Information" of this catalog (p. 7)