



COMPANY WITH
QUALITY SYSTEM
CERTIFIED BY DNV GL
= ISO 9001:2015 =



USER MANUAL

EP7 BATTERY-POWERED ELECTRONIC POSITION INDICATOR

Manual purpose

This manual has been designed by the Manufacturer to provide the necessary information regarding the EP7 instrument to those who are authorized to carry out safely its installation, maintenance, dismantling and disposal. All the necessary information for buyers and planners can be found in the sales catalogue. In addition to adopting good technical construction methods, this information should be read carefully and strictly applied. Nonobservance of this information could cause risks for the health and safety of people and economic damage. This information, provided by the Manufacturer in the original language (Italian) is also available in other languages to satisfy legislative and/or commercial needs. This manual must be kept in good conditions by a responsible person in an ideal place so that it is always available for consultation. In case this manual is lost or deteriorates, a replacement should be requested directly to the manufacturer quoting the manual code. This manual reflects the state of the instrument at the time of input in the market: however, the manufacturer reserves the right to make changes, add or improve the manual without notice.

Identification of the product

The identification label is applied on the instrument.

To determine the identification code of the instrument, consult also the sales catalogue.

Environmental conditions

Temperature range: min. 0°C - max. +50°C.

It is forbidden to use the instrument other than for its intended use and in potentially explosive conditions or where anti-explosive elements are used.

Storage

Here below are some recommendations to be followed for the storage of the instrument:

- Avoid environments with excessive humidity and those exposed to bad weather (avoid open areas).
- Avoid placing the instrument directly on the ground.
- Store the instrument in its original packing.

Conformity declaration and EC marking

The instrument respects the following EC Community Directive:
2014/30/EU Electromagnetic compatibility, 2011/65/EU RoHS.

Maintenance

The instrument does not require particular maintenance except cleaning, to be done only with a soft cloth slightly damped with ethylic alcohol or water. Do not use hydrocarbon solvents (petrol, thinners, etc.): the use of these products could affect the proper functioning of the instrument. Repairs should be done only and exclusively at the FIAMA technical assistance centre.

Calibrations and tests

It is advisable to calibrate the instrument periodically, once every working year.

To do the calibration, follow the procedure indicated in the present manual.

Assistance request

For any kind of technical assistance request, contact the sales department of the Manufacturer directly indicating the information given on the identification label, the number of hours used and the type of defect.

Manufacturer's responsibility

The manufacturer declines any responsibility in case of :

- Use of the instrument contrary to the national safety and accident-prevention laws.
- Incorrect installation, incorrect procedures or nonobservance of the instructions provided in the present manual.
- Defective electrical power supply.
- Modifications or tampering.
- Operations carried out by untrained or unqualified staff.

The safety of the instrument also depends on the strict observance of the procedures indicated in the manual: always operate the instrument in its functioning capacity and carry out a careful routine maintenance.

Note:

- All phases of inspection and maintenance should be carried out by qualified staff.
- The configurations provided in the manual are the only ones permitted.
- Do not try to use the instrument in any way which is contrary to the provided indications.
- The instructions in this manual do not substitute but are complimentary to the obligations of the applicable legislation regarding safety laws.

Installation

Before installing the instrument, take note of the following warnings:

- a) Connect the instrument following strictly the instructions of the manual.
- b) It is the responsibility of the user to check, before using, the correct settings of the parameters of the instrument to avoid damage to persons or things.
- c) The instrument **MUST NOT BE IN FUNCTION IN A DANGEROUS ENVIRONMENT** (flammable or explosive).
- d) The unit has parts sensitive to electrostatic charges, therefore handling of the inner electronic parts must be carried out with appropriate care to avoid permanent damage.

Description

The electronic position indicator EP7, supplied with an internal battery, integrates in the same case a position sensor and a display unit, and constitutes a device for measuring linear or angular movements: it is compact, easy to install and applicable in many types of industry (packaging, woodworking, aluminum, coil, etc.)

The display has 5 digit plus a sign (range -99999 +99999) with 7,5mm-high digits that allow an excellent readability also at a distance.

With the 3 frontal buttons it is possible to program the value on the display for each turn of the hollow shaft and activate the following functions: reset/preset of the displayed value, absolute/relative displayed value, mm/inches conversion.

There are also 3 distinct origins available for the correction of the displayed value when using different tools and the offset function for the compensation of tool wear.

On the display all activated functions are showed by a symbol.

The electronic parts are protected inside an elegant and resistant case made of self-extinguishing and shock-proof plastic material.

The power supply is internal and is based on a single $\frac{1}{2}$ AA 3,6V battery which has a typical 4 year lifetime. Low-power is indicated on the display with an icon; battery substitution is very easy and does not cause loss of the correct displayed value when carried out without moving the shaft.

Mechanical installation

Fit the EP7 through its hollow shaft onto the machine shaft, taking care that the lock pin fits correctly into the $\varnothing 6$ mm hole.

For this purpose, prepare the hole for the lock pin (bore 6,1mm, depth 6mm) ensuring that the distance between the axis of the hole and the axis of the drive shaft is 30mm, see image 1 and 2 below. Then fit the instrument in and fix it with 2 M4 screws placed on the hollow shaft, see image 3 and 4.

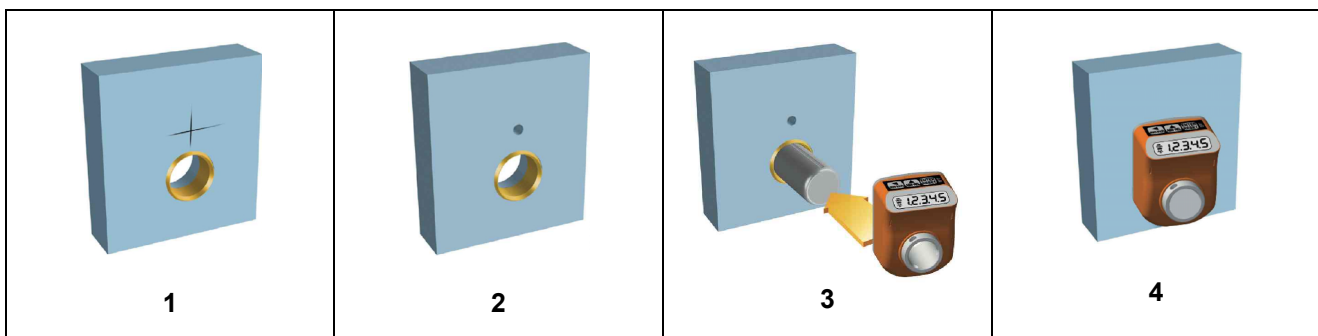

Programming

To access programming of the parameters, keep ▲ pressed until *PASS* appears on the display. Now press 2 times **ENTER/RESET** and 3 zeroes will appear. The first digit on the right will be blinking: with ▲ (digit increase) and ◀ (digit selection) insert the pass code which is **273** and confirm with **ENTER/RESET**. In case of incorrect insertion of the password, the unit exits programming.

The various parameters can be scrolled with ▲ and in order of appearance they are:

- UI 5* value to be displayed after one complete rotation of the shaft
- ndEC* number of decimal places
- FAST* button activation mode *
- dir* counting direction

* When the Offset, Preset, and Origin Change functions are set, also the *OFFSE*, *PrSE*, *PrSD*, *PrSI*, *PrSZ* parameters will appear (see further below).

To modify the selected parameter press two times **ENTER/RESET** (the first time displays only the value). With ▲ and ◀ set the desired value and confirm with **ENTER/RESET**.

To set a negative number, press ◀ until the last digit on the left blinks then press ◀ once again and after press ▲ so that the minus sign will appear.

To exit programming press ◀.

Value to be displayed after one complete rotation of the hollow shaft: *UI 5*

This parameter, together with the following one, defines the value which is displayed after one rotation of the hollow shaft. The allowable range is from 0,0001 to 99999.

The decimal place is set after programming the last digit on the left: after pressing ◀, the decimal place will blink and with ▲ it can be moved to the desired position. Confirm with **ENTER/RESET**.

Number of decimal places: *ndEC*

It is the number of decimal places to visualize on the display, allowed range from 0 to 4.

Example 1: if each rotation of the hollow shaft will cause a displacement of 50, set *UI 5*=50 and *ndEC*=0.

Example 2: if each rotation of the hollow shaft will cause a displacement of 12,345 and the desired output on the display is 12.3, set *UI 5*=12.345 and *ndEC*=1.

Button activation mode: *FAST*

This parameter programs the button functions.

The value is a number with 3 digits, each corresponding to a button: the digit on the right sets the **ENTER/RESET** button, the digit in the middle sets ▲ while the last digit on the left sets ◀.

The possible values are in the following table:

VALUE	◀	▲	ENTER/RESET
0	Not active	Not active	Not active
1	mm/inch conversion	abs/rel measurement	Reset
2	Not active	Not active	Preset
3	Not active	Not active	Fast Preset
4	Not active	Not active	Change of origin 0,1,2
5	Not active	Not active	Offset
6	Not active	Not active	Fast Offset
7	Not active	Not active	Delayed reset * (after 3s)
8	Not active	Not active	Delayed preset * (after 3s)

* Delayed means that to activate the function (reset or preset), it is necessary to keep **ENTER/RESET** pressed for approximately 3 s.

Reset: reset function of the displayed value; after pressing **ENTER/RESET**, the displayed value is set to zero.

Preset: preset function of the displayed value; after pressing **ENTER/RESET**, the displayed value becomes equal to the value in the **Pr5t** parameter, which can be set immediately after **tRStI** (when the digit on the right is set to 2).

Fast Preset: the fast setting of the displayed value on the display; after pressing **ENTER/RESET** **Pr5t** appears and pressing 2 times **ENTER/RESET** it is possible to set the value directly (use ▲ and ◀ and then confirm with **ENTER/RESET**). This function is useful when the displayed value must be corrected often.

Origin change (correction of the displayed value for tool changes): with this function 3 different origins (0,1,2) can be set and with **ENTER/RESET** it is possible to switch from one origin to another. After setting 4 in the first digit on the right of the **tRStI** parameter, **Pr50** will appear and after pressing 2 times **ENTER/RESET** it is possible to set the nominal value for tool 0 (for example the radius of cutter 0), which is then confirmed by pressing **ENTER/RESET**.

Now **Pr51** will appear which is the nominal value for tool 1 (for example the radius of cutter 1): set the correct value and confirm with **ENTER/RESET**.

Finally **Pr52** will appear which is the nominal value for tool 2 (for example the radius of cutter 2): set the correct value and confirm with **ENTER/RESET**.

In practice **Pr50**, **Pr51**, and **Pr52** are the nominal values associated to the three different tools which are used.

As a special case, if **Pr50** is set to zero, **Pr51** and **Pr52** are the values to display in origin 1 and in origin 2 respectively.

ABS/REL function: Enables passing from an absolute to relative value; after pressing ▲, the displayed value is temporarily set to zero to measure a relative motion of the shaft. On the display the **REL** icon indicates that the current display is relative to the reference point that has just been created. Pressing again ▲ causes the absolute value to be displayed and the **ABS** icon will appear.

mm/inch conversion: Pressing ◀ converts the measurement from millimeters to inches and back. When in inch mode, the **INCH** icon will appear and the displayed value will have an additional decimal place. When the parameter **ndEC=4** the mm/inch conversion is not available.

Offset: This parameter is added to or subtracted from the displayed value to correct it in case, for example, of a tool change or to compensate tool wear. After setting a positive offset value, the displayed value will be the measured value plus the offset value. After setting a negative offset value, the displayed value will be the measured value minus the offset value.

Fast Offset: After pressing **ENTER/RESET**, **OFFSt** appears and by pressing two times **ENTER/RESET** it is possible to set directly the value to be displayed (use buttons ▲ ◀ and confirm with **ENTER/RESET**). This function is useful if it is necessary to correct often the displayed value.

Counting direction d/r

It sets the counting direction, allowed values 0 or 1.

By setting 0, the displayed value increases turning the shaft clockwise.

By setting 1, the displayed value decreases turning the hollow shaft clockwise.

Adjustment of displayed value

After the installation of instrument on the machine and setting of all parameters, in order to visualize on the display the correct value it is necessary to carry out the reset or preset.

Position the shaft in a point in which the correct measure that has to be visualized is known exactly (for example the stroke end point) or measure the position in that point of the shaft. Program parameter **tRStI** with value 3 in the first digit on the right and exit programming.

Now press **ENTER/RESET** and **PrSt** will appear, press again 2 times **ENTER/RESET** and set the correct value to display, then confirm with **ENTER/RESET**. The display will now show the desired value.

If the required value is zero, instead of the preset function it is possible to use the reset function by setting 1 in the first digit on the right in the **LRStI** parameter so that pressing **ENTER/RESET** will bring the displayed value to zero.

Now that the instrument is adjusted, it is necessary to insert the desired **LRStI** parameter to avoid accidental reset/preset of the displayed value.

Battery replacement

The instrument is supplied with a ½AA 3,6V lithium battery, which assures a typical functioning of approximately 4 years.

When the battery runs down, an icon appears on the display.

To enter into the battery-holder it is necessary to remove the front cover by carefully inserting a flat screwdriver on the sides. After taking off the cover, pull the battery out and substitute it with a new one, paying attention to the polarity: the positive pole must face the side of the **ENTER/RESET** button. The instrument is protected against inversion of polarity and wrong insertion, and in this case will not switch on.

Removing the battery from the instrument switches it off after a few seconds: at this point do not rotate the hollow shaft to avoid losing the correct displayed value. As soon as the battery is fitted, the instrument switches on with the same value on the display which was present at the moment when it was switched off. If the shaft has not be moved, the displayed value will be correct. In case the shaft moved when the instrument was off, to re-establish the correct measure it is necessary to repeat the adjustment process.

Display icons



1. Indicator of low battery, it is activated when is it necessary to change the battery.
2. Indicator of inches measurement.
3. Indicator for origin 1 and 2
4. Indicator of relative displayed value.
5. Not used.

Error message

oUEr: the current displayed value passed the maximum value that can be visualized (possible range: from -99999 to 99999).

Dimensions

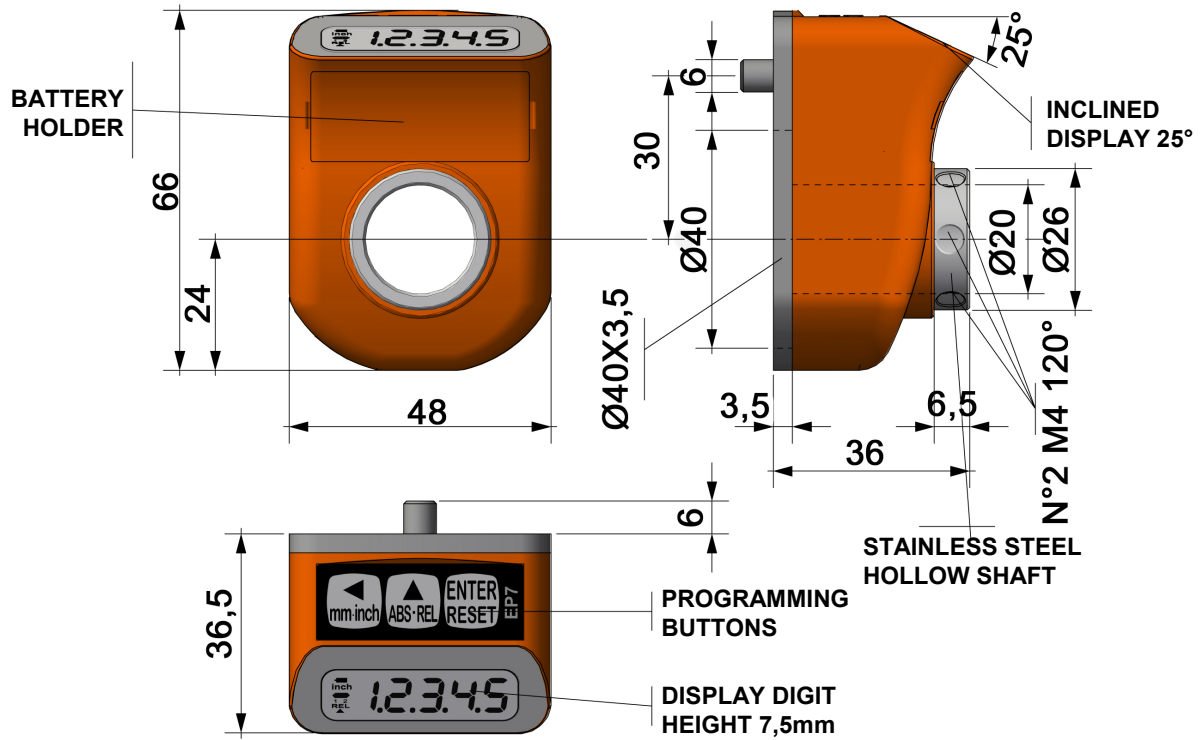

View A



View B



General characteristics

Hollow shaft diameter	20mm H7, 14mmH7
Max. rotation speed	1000 RPM for brief periods
Resolution	4000 impulses/revolution
Range	-99999; 99999
Display	High readability LCD with 7.5mm high digits
Keyboard	3 digits for programming and functions activation
Available functions	reset/preset, absolute/incremental value, mm/inch conversion, 3 distinct origins for tool changing
Power supply	battery 1/2 AA, voltage 3,6V (lithium thionyl chloride)
Battery life	Typical 4 years continuous use
Weight	100g
Protection degree	IP54
Working temperature	0-50°C
Relative humidity	35-85%
Electromagnetic compatibility	2014/30/EU
RoHS	2011/65/EU

Manufacturer

All communications to the manufacturer should be addressed to:

FIAMA s.r.l.
Via G. Di Vittorio, 5/A
43126 San Pancrazio (Parma) - Italy
Tel. (+39) 0521.672.341
Fax. (+39) 0521.672.537
e-mail: info@fiama.it
web: www.fiama.it

FIAMA srl is not responsible for any damage to persons or things caused by tampering and by incorrect use and in any case which is not conforming to the features of the instrument.

